

SLAB MArch
Edward Smith

This is student work produced at specific universities; please credit everyone accordingly.

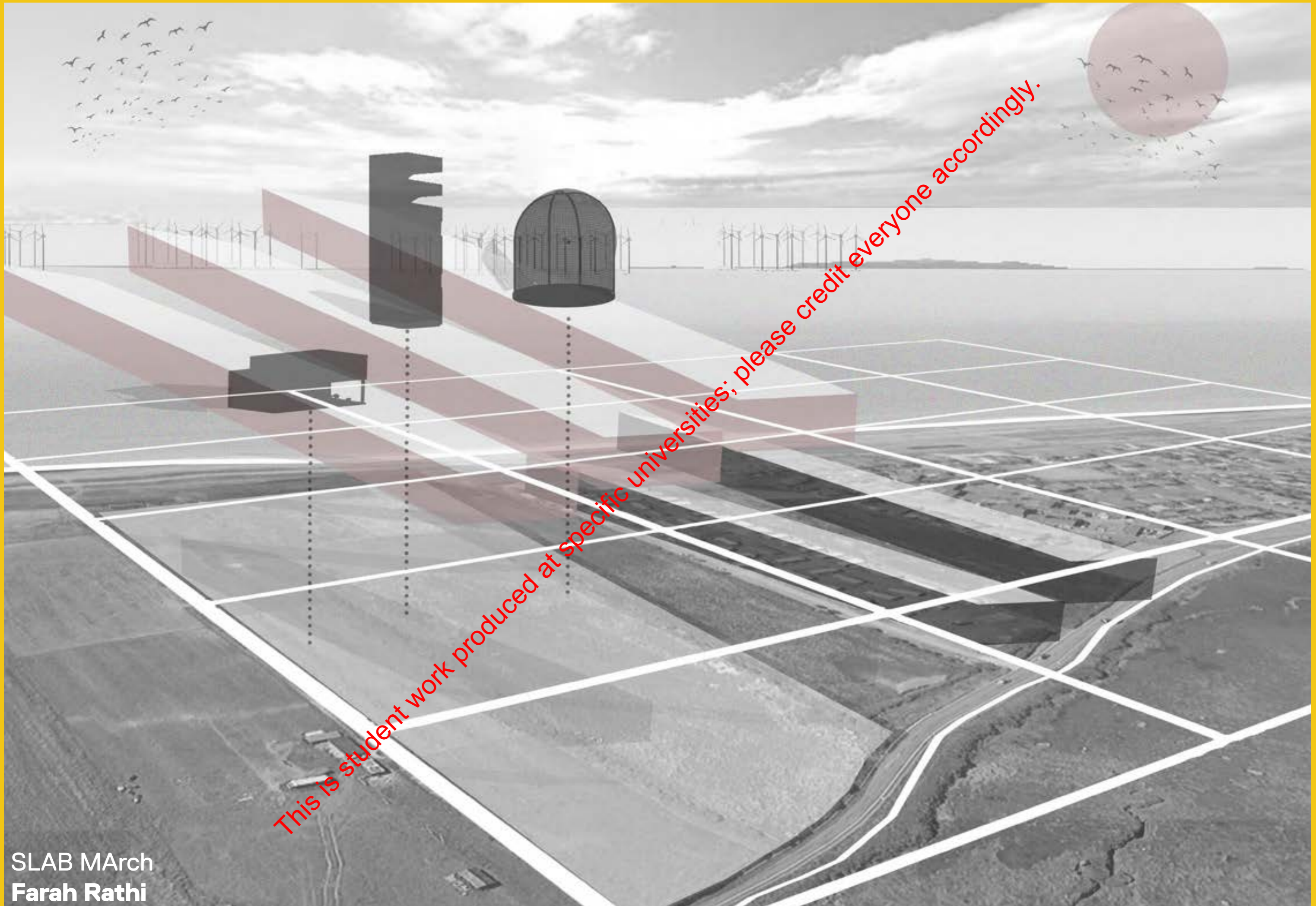

This is student work produced at specific universities; please credit everyone accordingly.

SLAB MArch
Farah Rathi



SLAB MArch
Hajar Al-Janabi

This is student work produced at specific universities; please credit everyone accordingly.



This is student work produced at specific universities; please credit everyone accordingly.

SLAB MArch
William Thomas



SLAB MArch
Hicran Gokcen

NEXUS

WASTE MANAGEMENT & LEISURE COMPLEX

Jack Smedley
Master of Architecture 2
University of Salford

Site Location:
Lowther, Cumbria

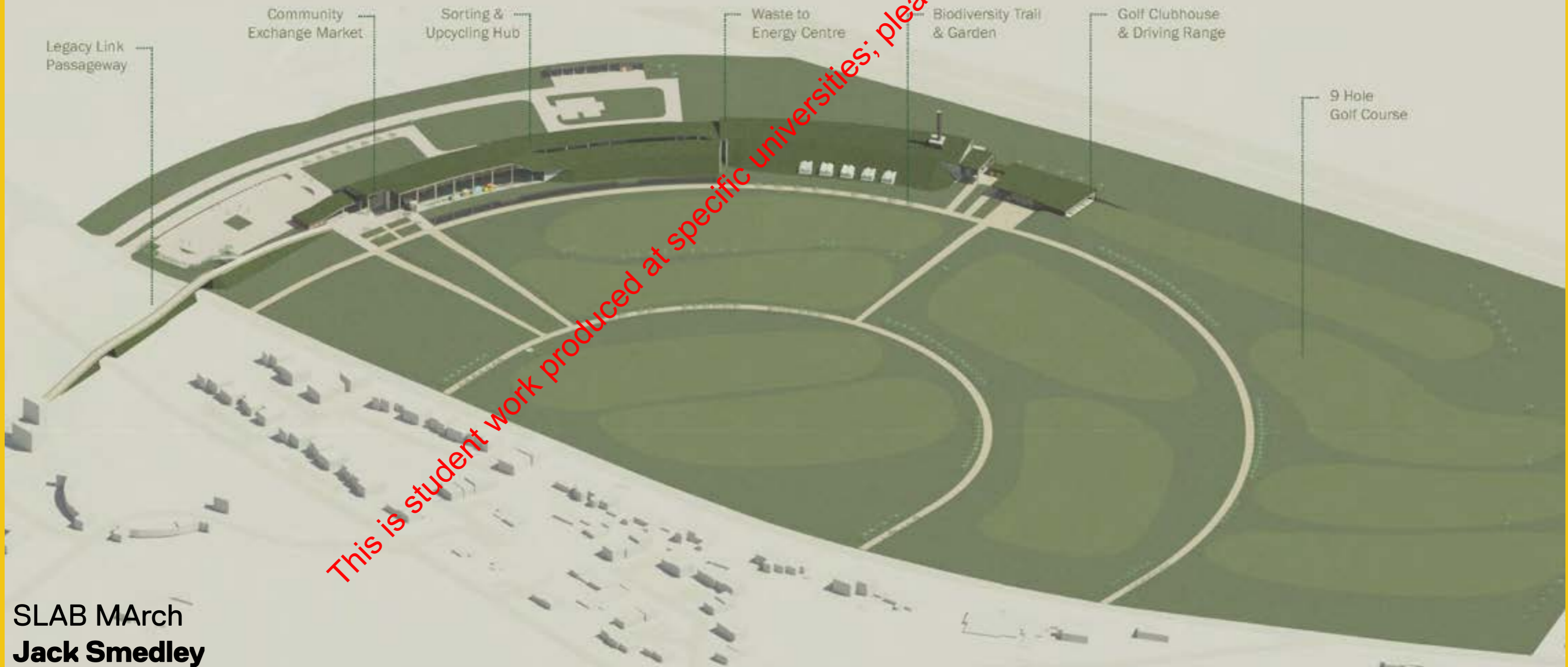

SLAB MArch
Jack Smedley

Museum for coal mining Disaster and research center



SLAB MArch
Noor Alsaffar

This is student work produced at specific universities; please credit everyone accordingly.

LANDSCAPE STRATEGY

LOST MAP

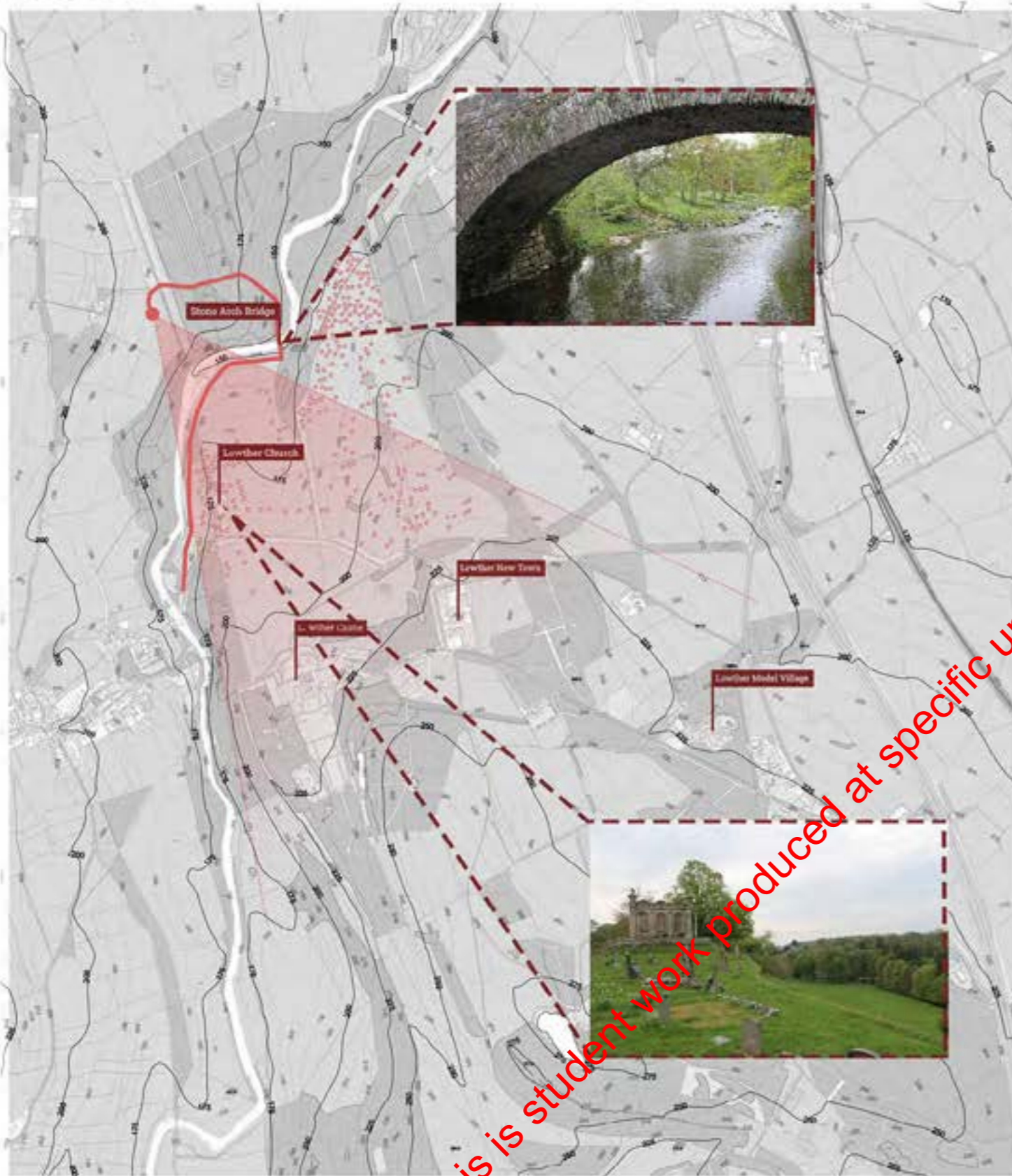

— LOST PATH

This is student work produced at specific universities; please credit everyone accordingly.

RESTORATION

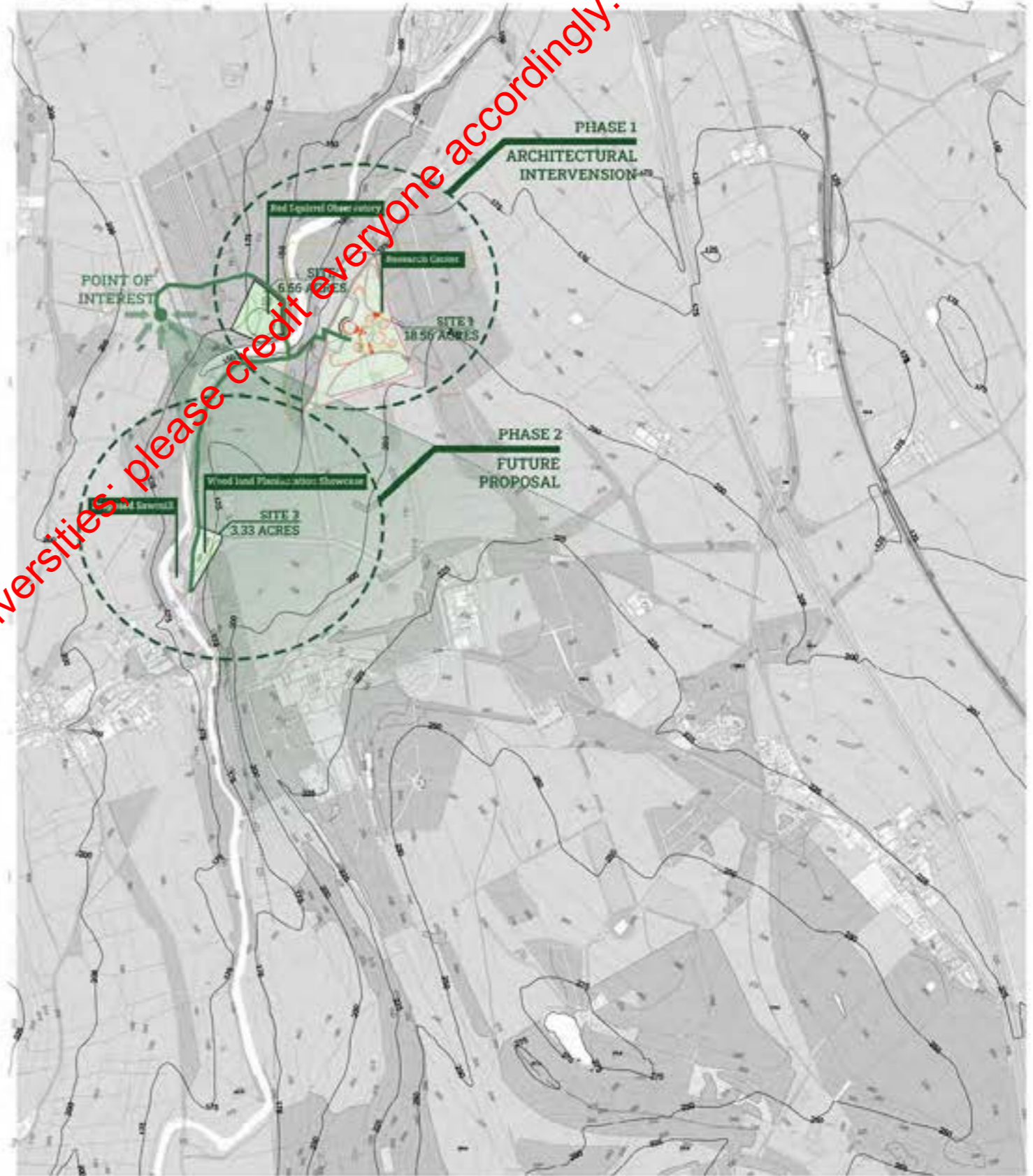

SLAB MArch
Saptarshi Sarkar

A lost walk in the midst of woodland, also mentioned by the famous poet William Wordsworth says that "the most beautiful specimen of a forest pathway ever seen by human eyes...". His signature was walks along Riverbanks. Starting at the church, the trail traversed the meadow and continued through old woods. Ascending the ever-narrowing path, the trail leaves the single-arch stone bridge and winds its way through woodland on higher ground. At last a spot is reached from where the faraway house and castle ruin stand out against a verdant ribbon of open meadow. On either side, there were clusters of towering Scots pine trees. The strategy aims to guide visitors along a journey through time, inviting them to reconnect with the historical significance of the landscape and restoring the panoramic vista from the elevated terrain where coniferous trees once thrived. By reinstat-

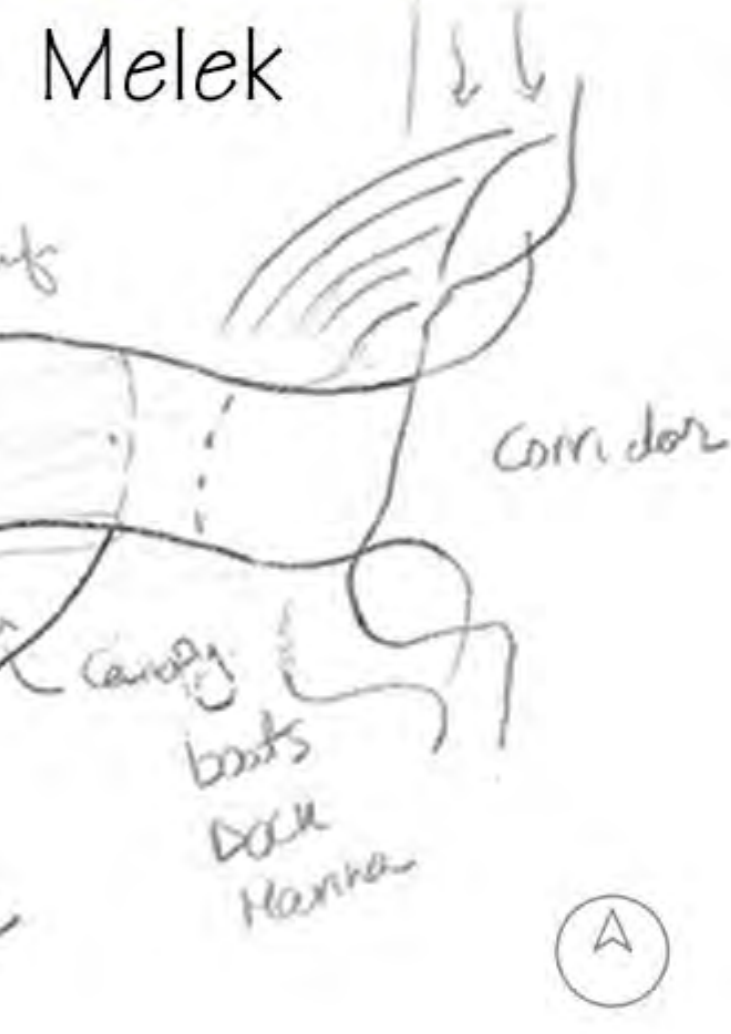
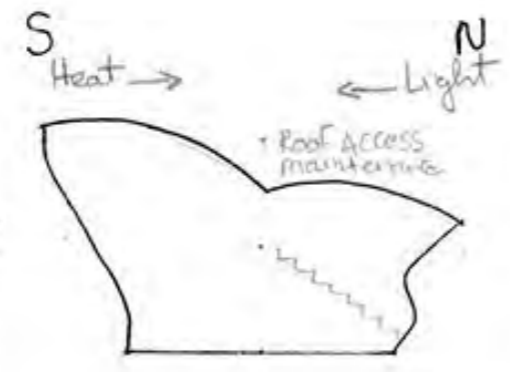
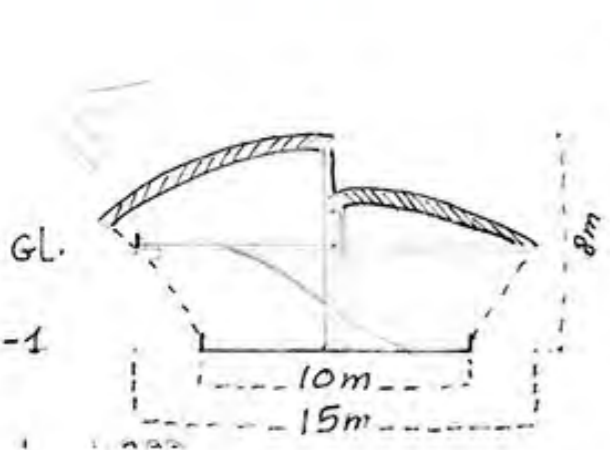
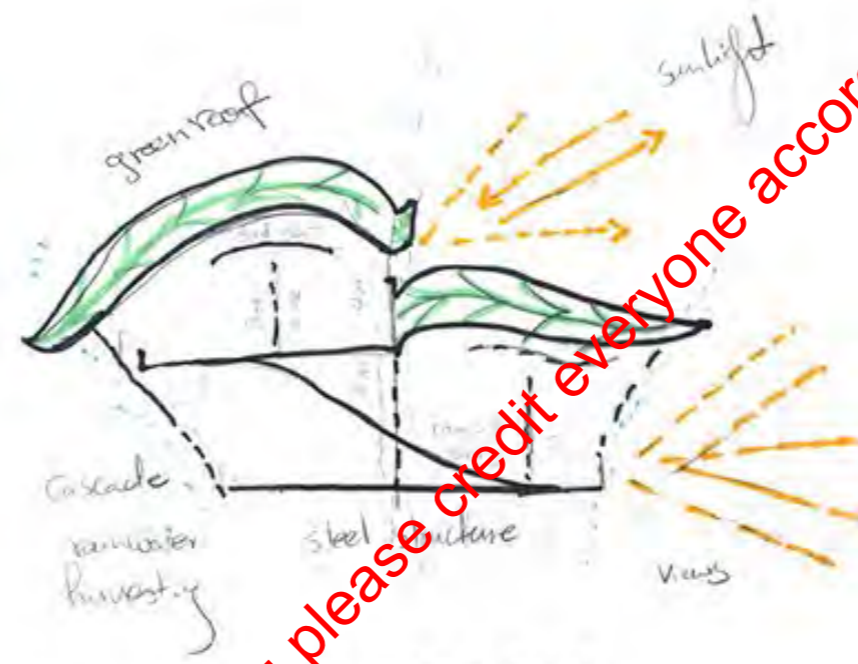
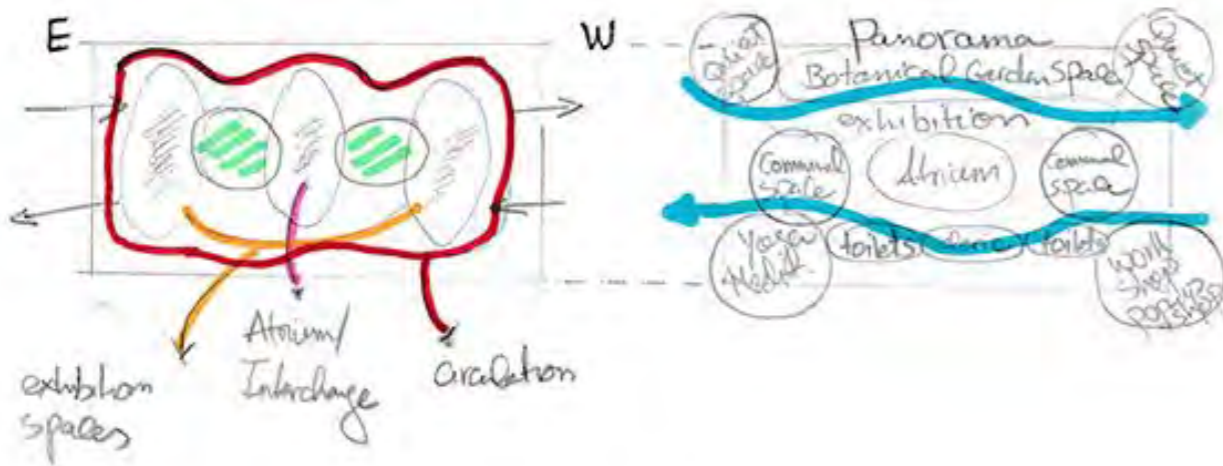

This is student work produced at specific universities; please credit everyone accordingly.

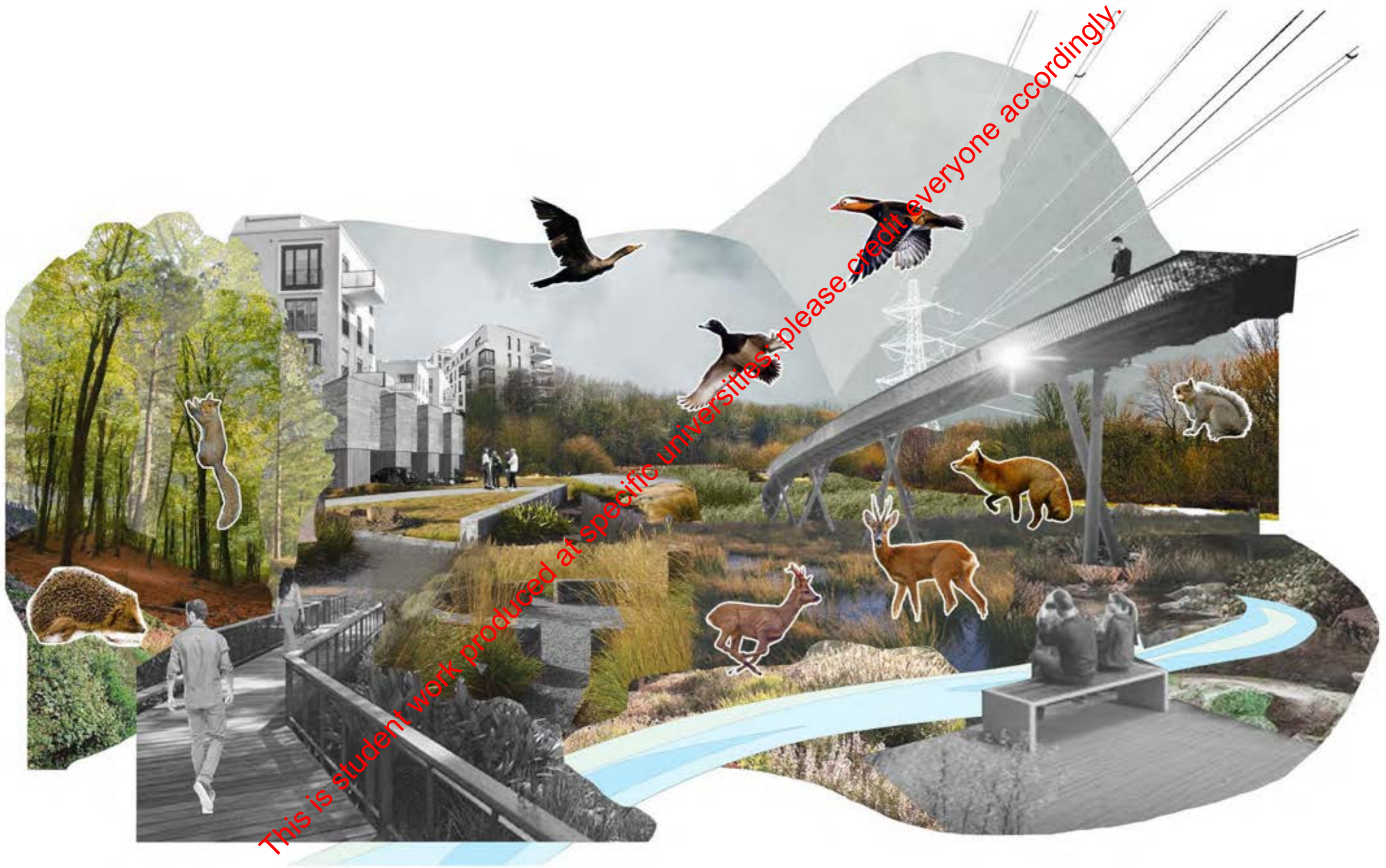

MSA MLA
Abhimanyu Ghosh

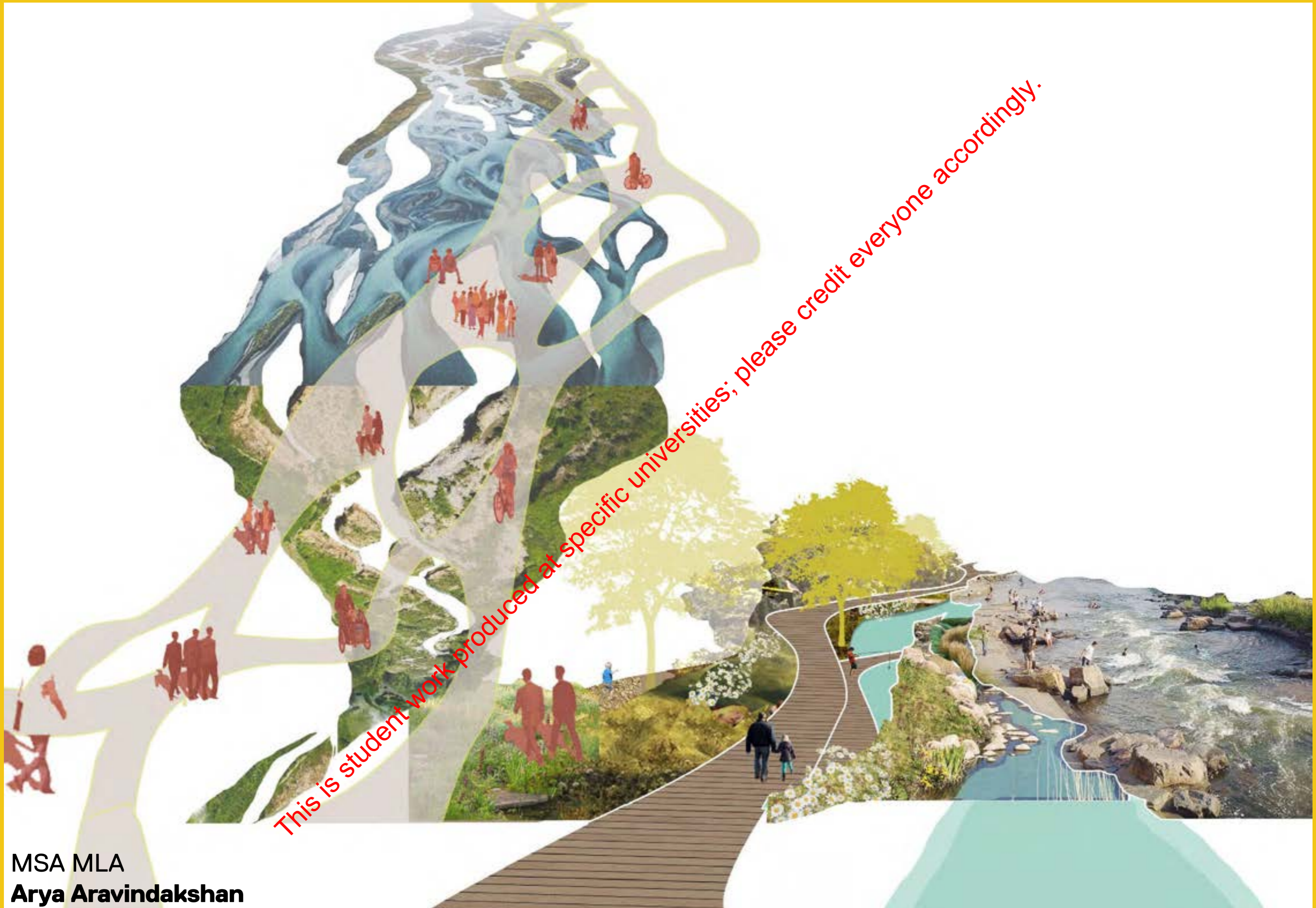

This is student work produced at specific universities; please credit everyone accordingly.



This is student work produced at specific universities; please credit everyone accordingly.

MSA MLA
Canyang Bao



This is student work produced at specific universities; please credit everyone accordingly.

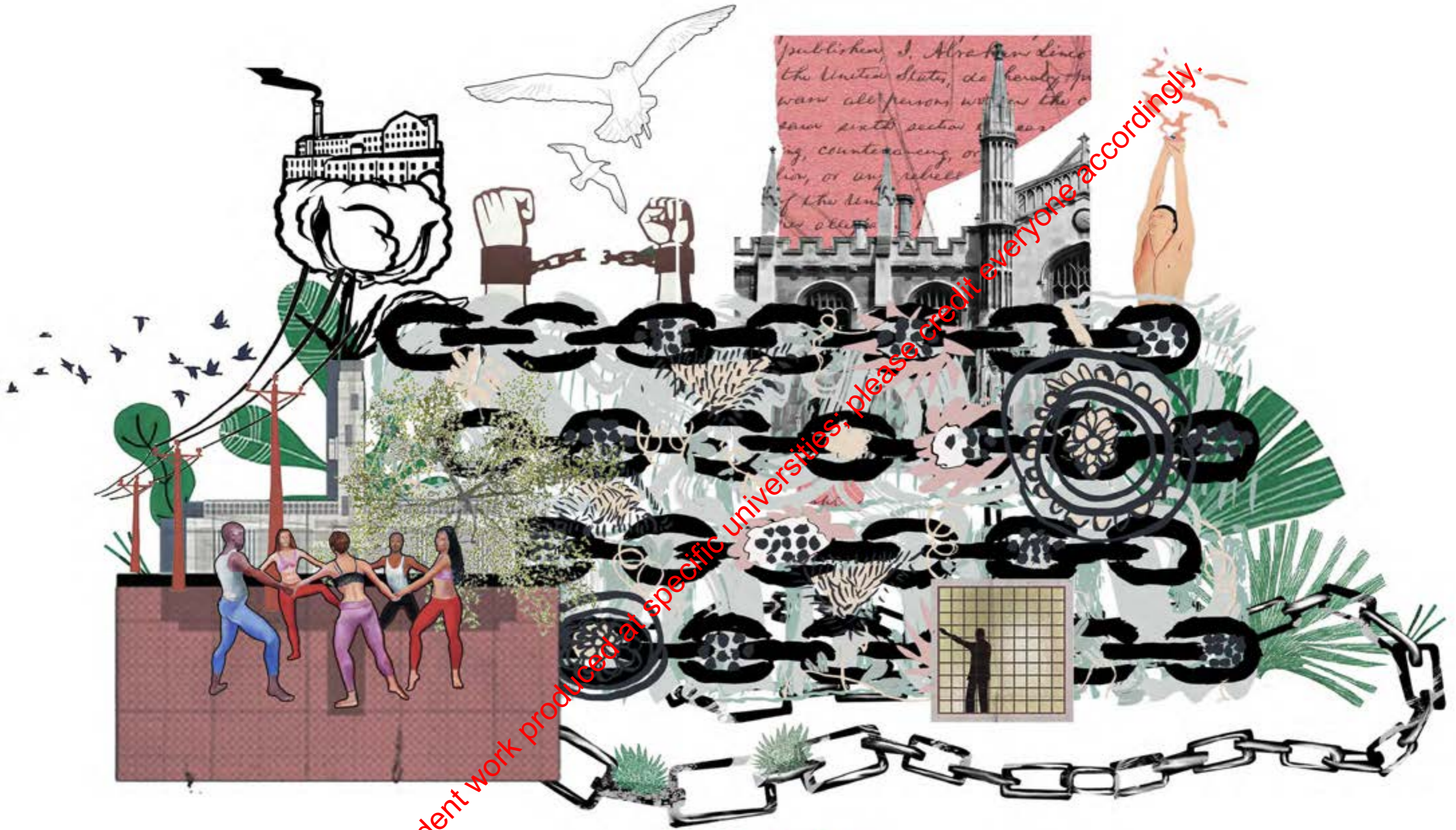

Blooming in chains

In such an important area of a city, we need a community bond that does not repeat the history of pain and sorrow, but builds a transformed and renewed community center that becomes a cradle of neighborhood culture and local people's lives, in the form of landscape architecture that heals, as far as possible, the wounds of history on the city and the people who were enslaved.



This is student work produced at specific universities; please credit everyone accordingly.



This is student work produced at specific universities; please credit everyone accordingly.



This is student work produced at specific universities; please credit everyone accordingly.

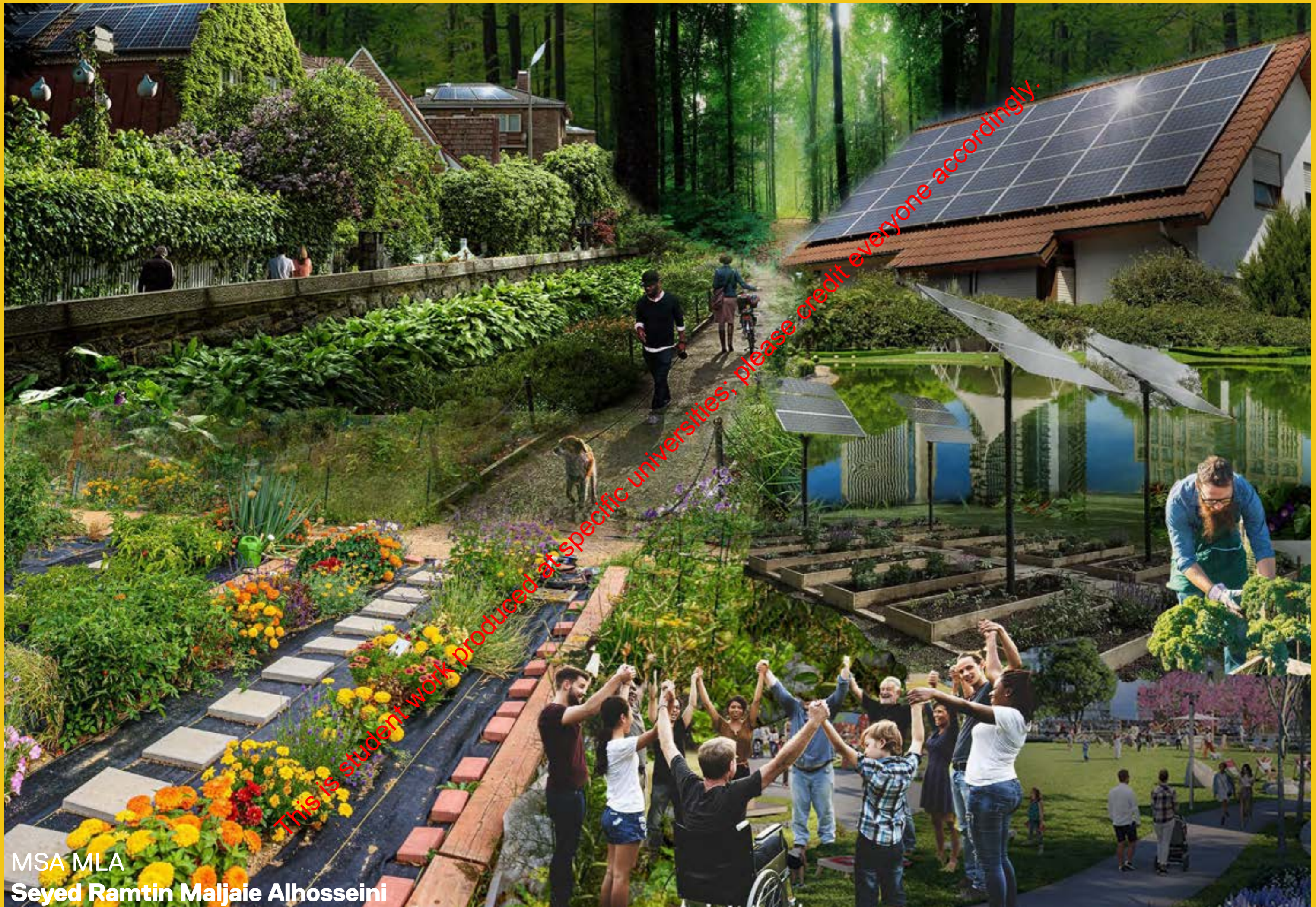

MSA MLA
Seyed Ramtin Maljaie Alhosseini

Everyone

This is student work produced at specific universities; please credit everyone accordingly.





This is student work produced at specific universities; please credit everyone accordingly.



MSA MLA
Xinjia Zhu

This is student work produced at specific universities; please credit everyone accordingly.

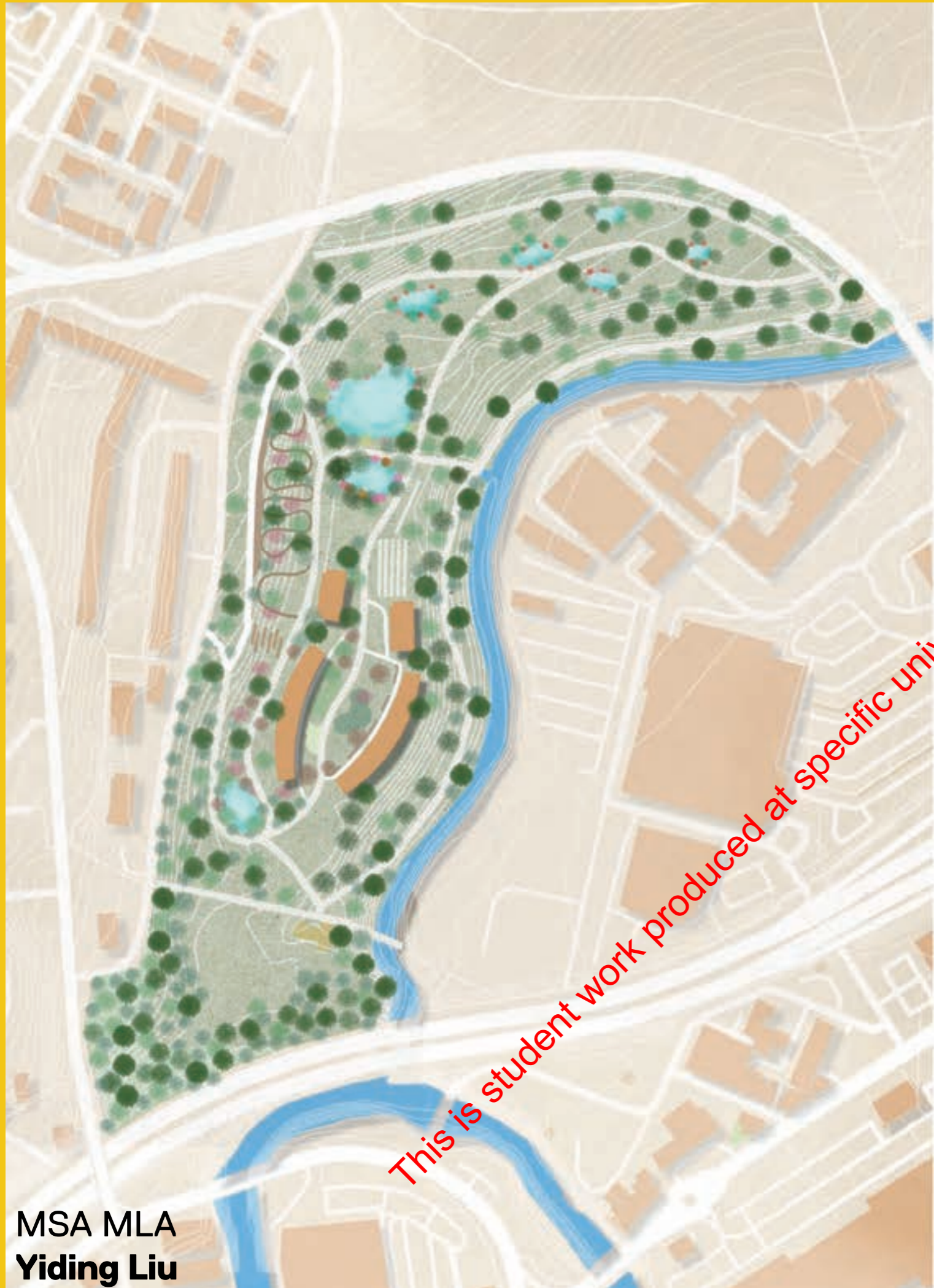

MSA MLA
Yiding Liu

This is student work produced at specific universities; please credit everyone accordingly.



SOCIETY

HUMAN

NATURE



This is student work produced at specific universities; please credit everyone accordingly.



This is student work produced at specific universities; please credit everyone accordingly.

Master plan (Middle of edditng...)



This is student work produced at specific universities; please credit everyone accordingly.

MSA MLA
Yuki Iijima

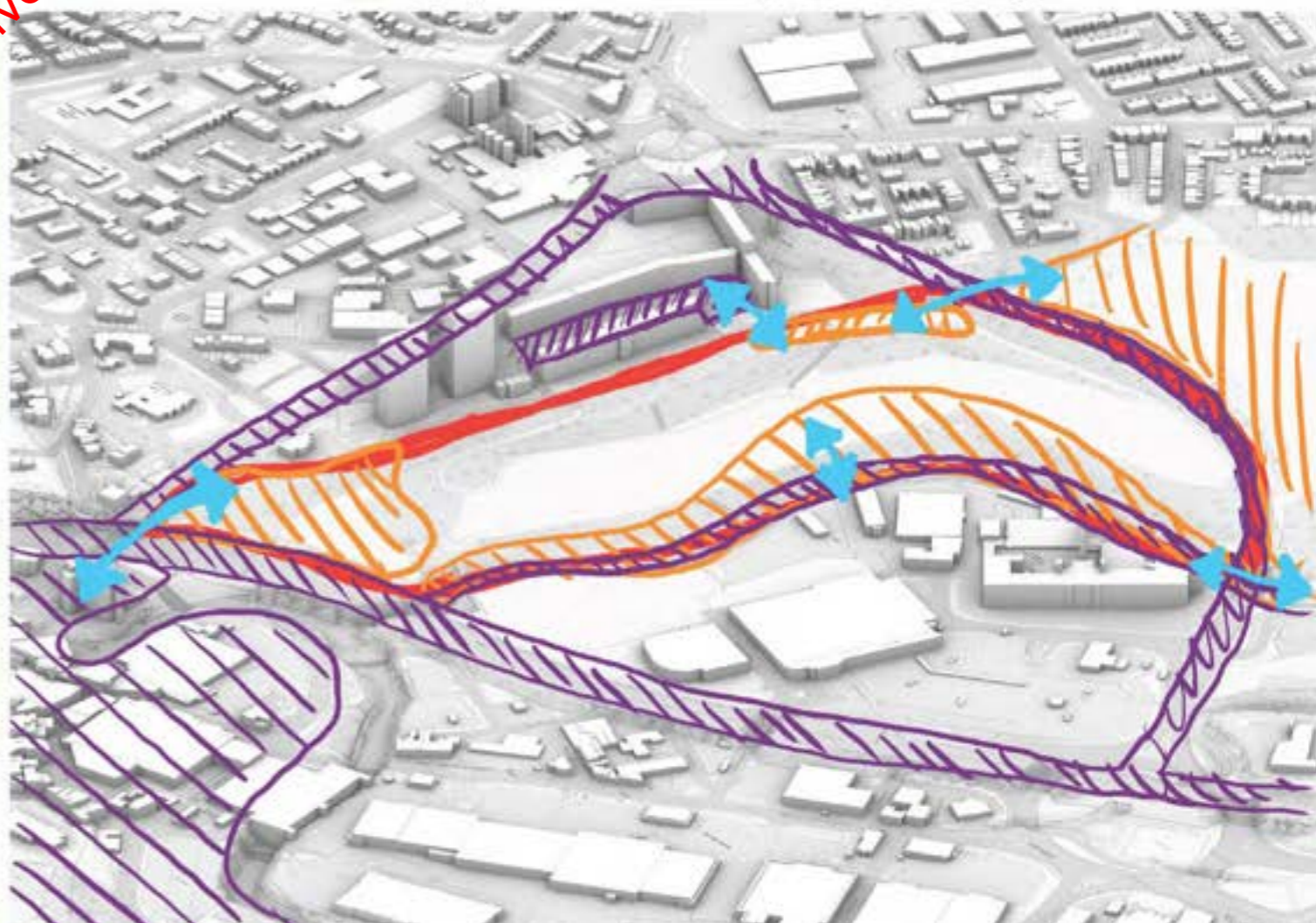
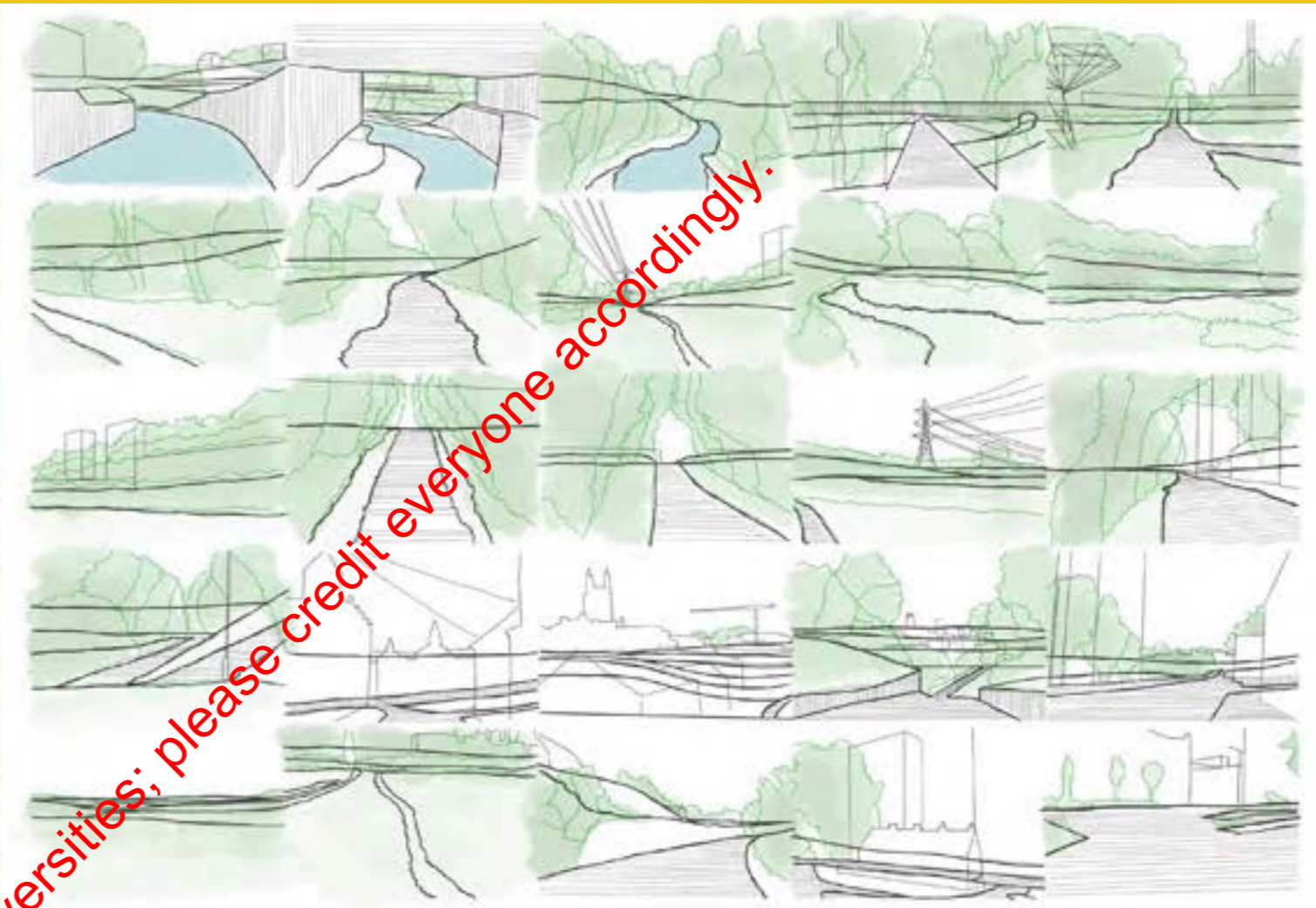

This is student work produced at specific universities, please credit everyone accordingly.

||| **BACK**
TO THE **NATURE** |||



MSA MLA
Yuqi Wang

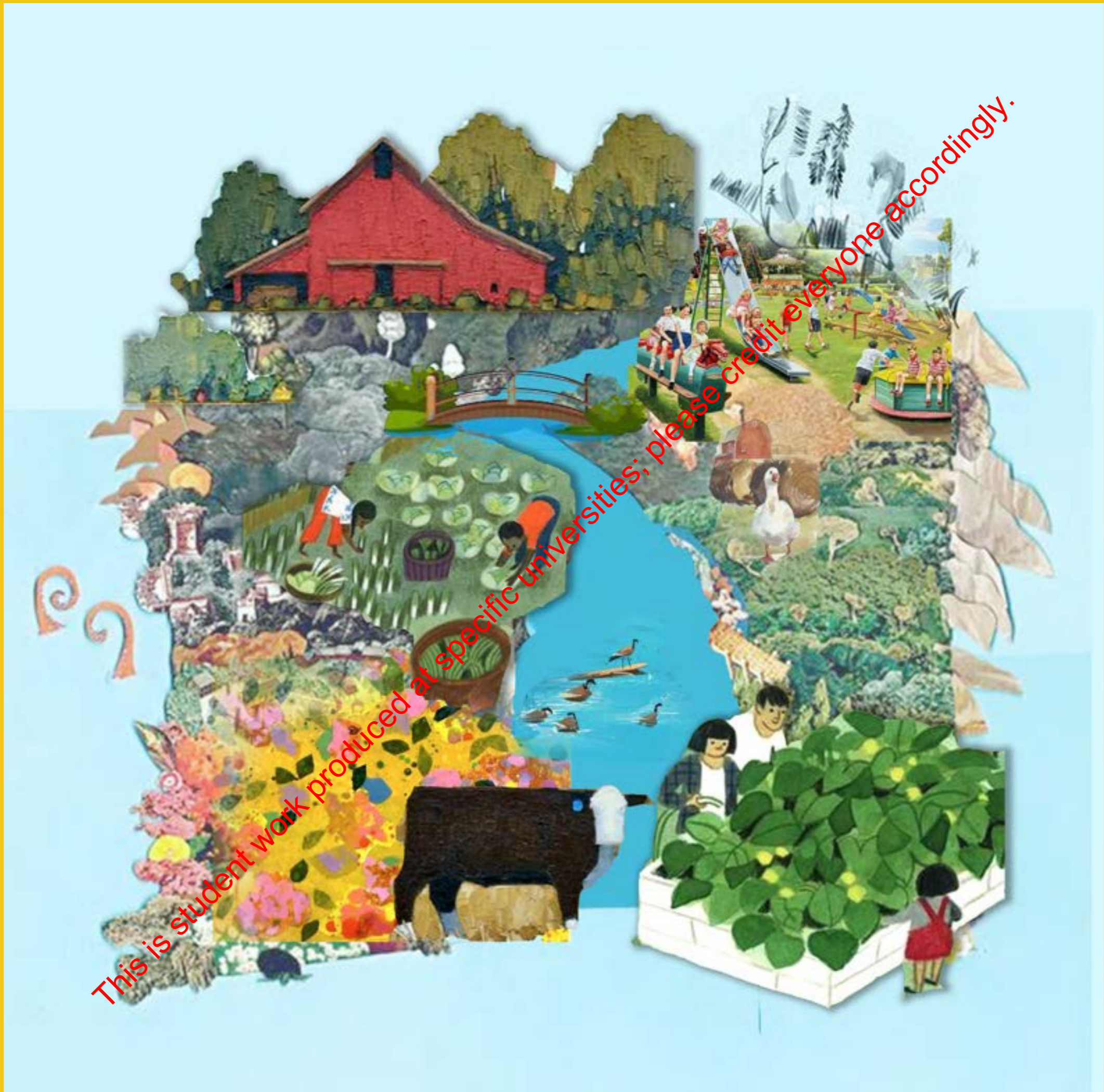



This is student work produced at specific universities; please credit everyone accordingly.

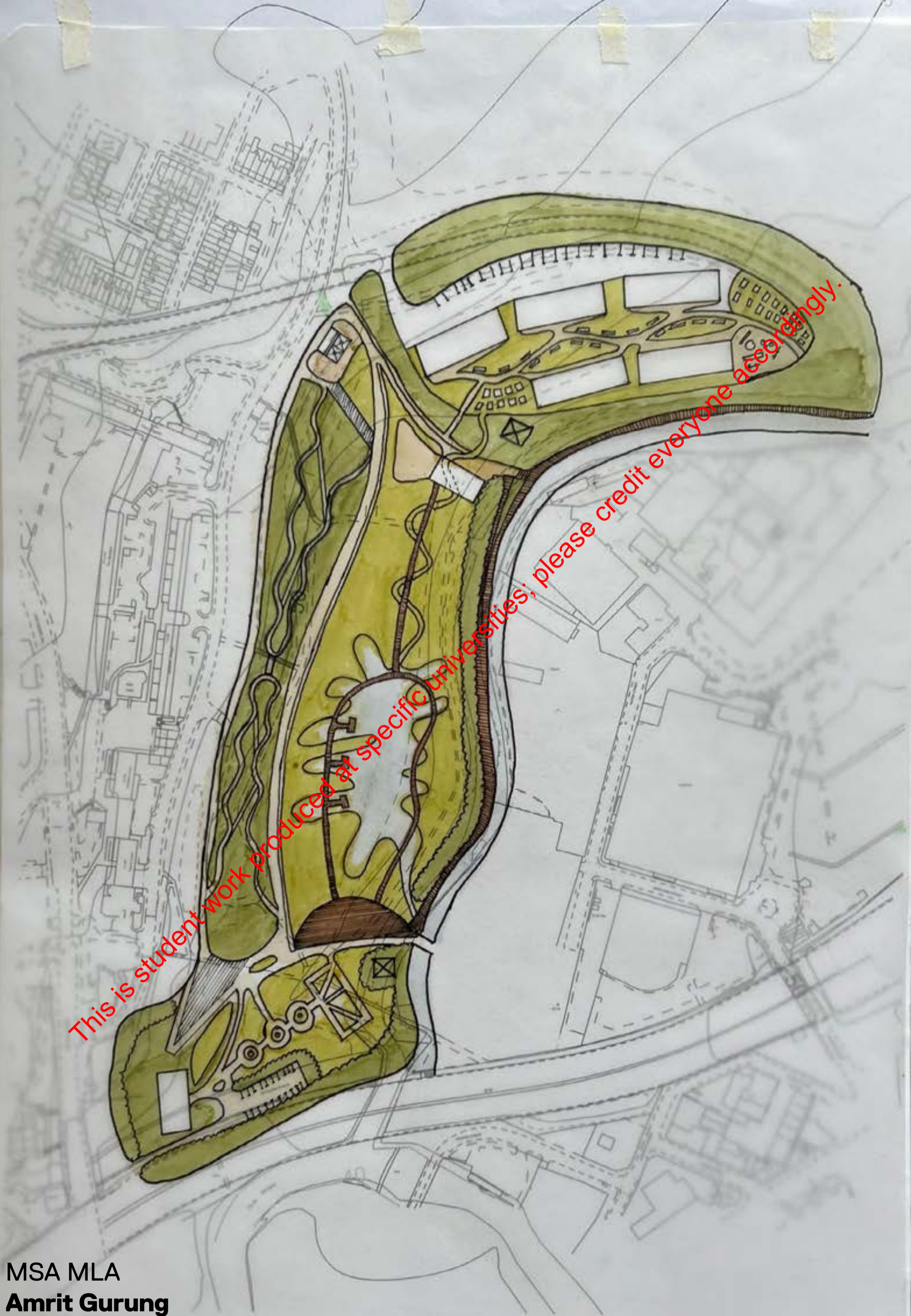

This is student work produced at specific universities; please credit everyone accordingly.



This is student work produced at specific universities; please credit everyone accordingly.



This is student work produced at specific universities; please credit everyone accordingly.

-  Public Road / Path
-  For Cars.
-  Landscapes / Exercise trail
-  Exercise site
-  Trees.
-  Green space.



This is student work produced at specific universities; please credit everyone accordingly.

SUSTAINABLE COUNTRY PARKS
WITH ACCESSIBLE GREEN SPACES
HAIMIN ZHU 23651879

MSA MLA
Haimin Zhu

ECONOMIC DEVELOPMENT

BIOLOGICAL CONSERVATION

RESIDENTIAL RESIDENCE

WATERFRONT SPACE



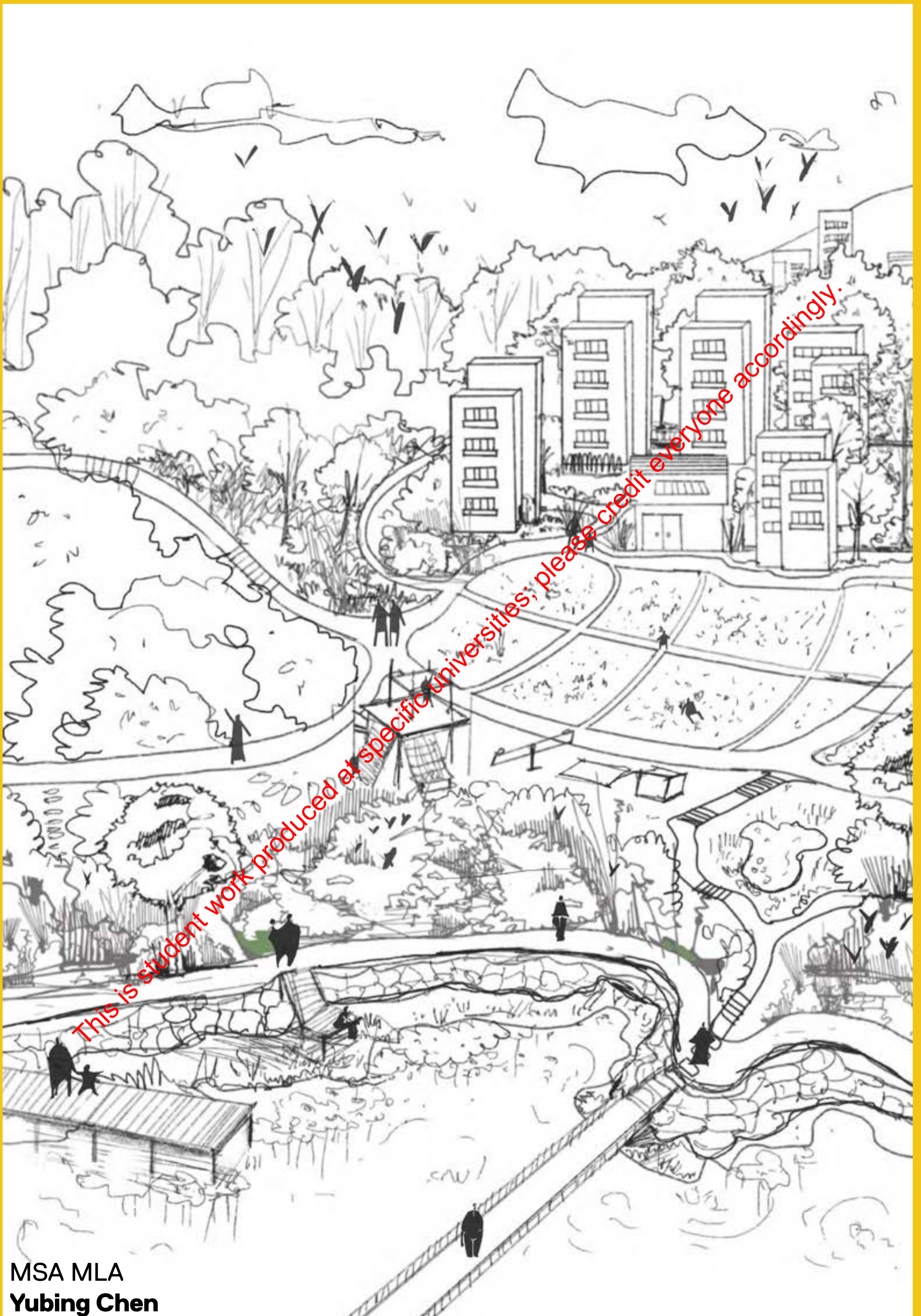

This is student work produced at specific universities; please credit everyone accordingly.

MANIFESTO

HELP BUILD A MORE

STOCKPORT

SUSTAINABLE + GREEN + INCLUSIVE

PRINCIPLES

- 1/ COMPLETE COMMUNITY
- 2/ PEOPLE-CENTERED SPACE
- 3/ CHOICES FOR SUSTAINABLE LIFE
- 4/ NATURAL BASED SOLUTION
- 5/ ECOLOGICAL CONNECTION
- 6/ RESILIENT TO CLIMATE CHANGE
- 7/ PLACES FOR EVERYONE
- 8/ FOCUS ON INEQUITY
- 9/ COHESIVE COMMUNITY

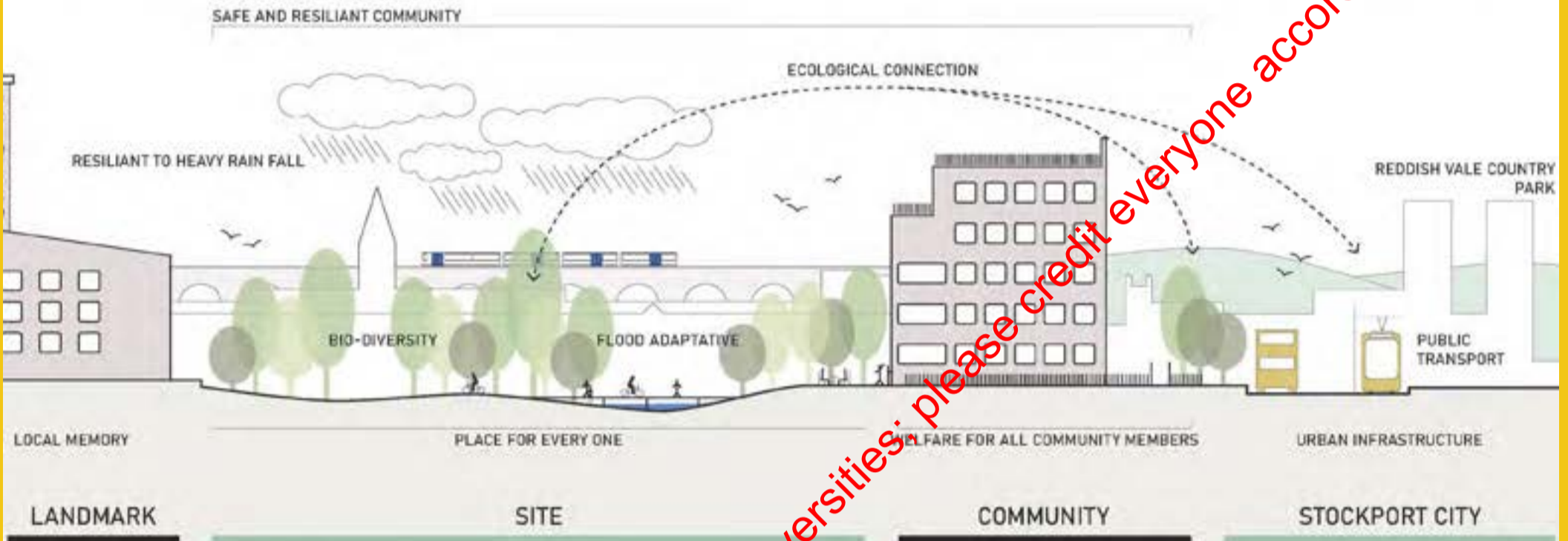

DESIGN STATEMENT & AIMS & OBJECTIVES

'Lancashire Hill Park'

Sustainable Residential Multi-functional Landscape

Responding to:
Local Strategies National Policies

Mainly Focuses on:
Improving Ecological Condition
Creating a Bond and Resilient Community

And Also tries to:
Respond to Local Social Injustices

- OBJ 1-3
 - ENHANCING NATURAL HABITAT
 - PROMOTING ECOLOGICAL CONNECTION
 - URBAN-RURAL TRANSFORMATION
- OBJ 4-6
 - BIKE VIEWING ROUTE
 - MULTI-ETHNIC ACTIVITIES
 - COMMUNITY GROWING SPACE
- OBJ 7-9
 - EQUAL ACCESS
 - MULTI-FUNCTIONAL SPACES
 - CLEAN WATER FOR EVERYONE

DESIGN VISIONS



VISION 01

VISION 02

VISION 03

This is student work produced at specific universities: please credit everyone accordingly.